



**BISON PRECAST**

a Forterra brand

# TECHNICAL GUIDANCE NOTE

Building Regulations Part A and E: dry bedding - 13 November 2017

## 1 Introduction

To meet the requirements of the current Approved Document A, for England and Wales, slabs must be built into walls to provide adequate lateral restraint. If for some reason the slabs cannot be built into the walls then restraint straps must be provided at a maximum spacing of 2m in accordance with clause 2C35. Effective restraint will be provided if the slabs have a minimum of 90mm bearing, either dry bedded or bedded. Where slabs span parallel to a wall then a bed of mortar must be provided to provide lateral restraint. Should a mortar bed be omitted then the restraint straps must be provided.

In addition to part A the requirements of Approved Document E must be met to mitigate the passage of sound. This can be met by the provision of a mortar bed. If a mortar bed is not provided then the gap between the slabs and the wall must be filled with a mastic sealant. This applies to parallel and perpendicular slab / wall junctions.

## 2 Typical details

Figures 1 to 3 show the details required in order to meet Part A and Part E of the Approved Building Regulations.

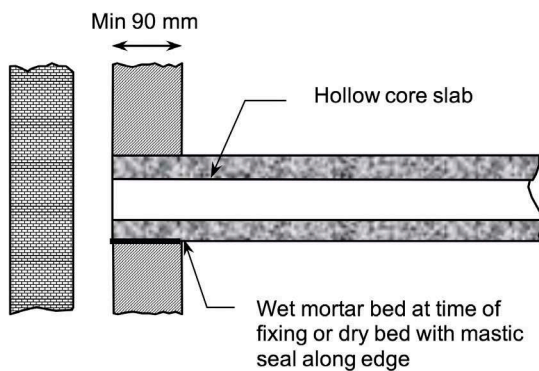

Figure 1 - Anchorage at bearing end

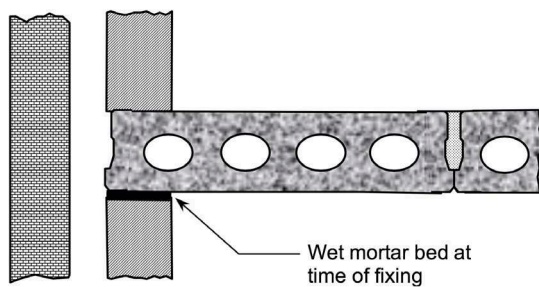

Figure 2 - Anchorage where a slab parallel to a wall is bedded

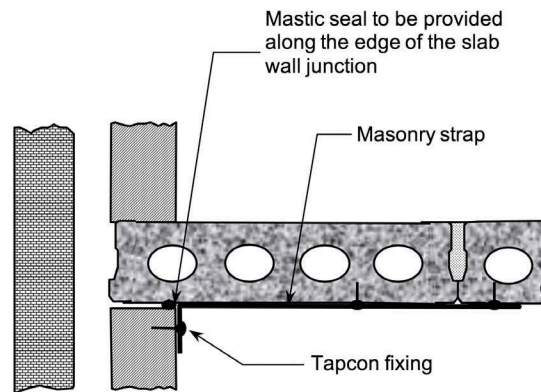

Figure 3 - Anchorage where a slab parallel to a wall is not bedded